

**TREK**



# 2023 CHECKPOINT ALR

SERVICE MANUAL SUPPLEMENT

# Contents



[Safety](#)



[Brake/shift routing — mechanical](#)



[T47 bottom bracket](#)

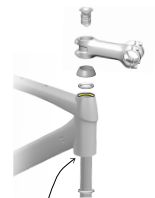

[Fork and headset](#)



[Chainkeeper](#)

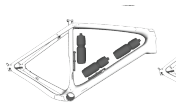

[Accessories](#)

**Specifications**

	Size
Head tube ID	42.0mm
Head tube OD	47.2mm
Head post clamp ID	31.5mm
Upper fork crown clamp OD	38.0mm
Lower fork crown clamp OD	38.0mm
Head tube ID - top bottom	42.0mm (2.0mm)
BB type - width	42.0mm (2.0mm)
BB shell diameter - max	42.0mm
Front derailleur clamp ID	31.5mm
Chainline (mm)	64.5mm (25.0mm)
Chainline (mm)	64.5mm (25.0mm)
Clearing min (mm)	44.0mm (1.7mm)
Clearing min (mm)	50.0mm (2.0mm)
Clearing min (mm)	54.0mm
Clearing min (mm)	56.0mm
Top width max (mm) (without handlebars)	450mm (17.7")
Top width max (mm) (with handlebars)	500mm (19.7")
Front wheel - max	Yes
Rear wheel - max	Yes
Rack mount	Yes
Chain and compatibility	Yes

[Specifications](#)

## Safety

### WARNING

#### Properly tighten hardware

Always tighten hardware to the specified torque. Over-tightening hardware could deform or break the hardware or components. Under-tightening hardware could cause hardware or components to become loose. Either situation could damage the bicycle and result in injury to the rider.

### WARNING

#### Reapply threadlocker

All reused-fasteners with pre-applied threadlocker must be cleaned with isopropyl alcohol and have new threadlocker applied before re-assembly. If threadlocker is not applied, the fasteners may loosen which could damage the bicycle and result in injury to the rider.

## Legend



Apply appropriate grease



Apply threadlocker



Nm Torque



Cable (zip) tie

# Brake/shift routing — mechanical

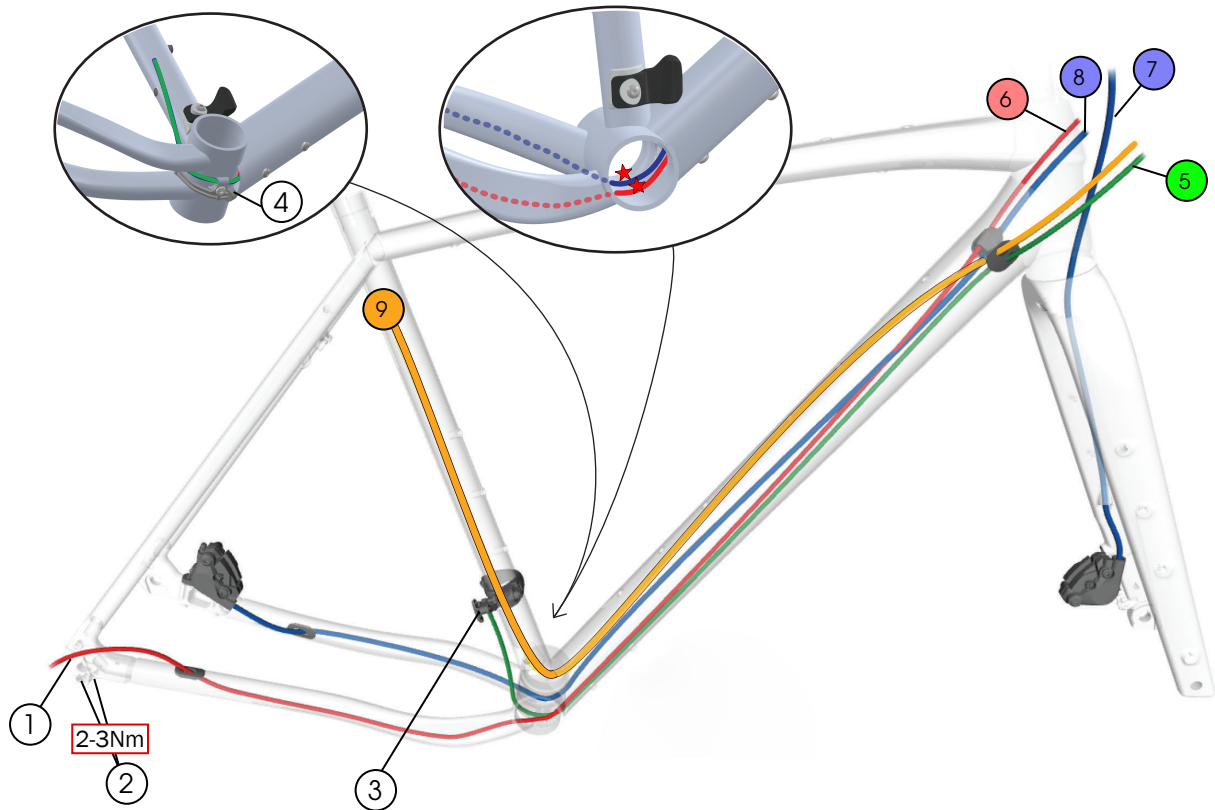

- ① Rear derailleur hanger — W524188
- ② Rear derailleur hanger bolts — W524884
- ③ Front derailleur clamp
- ④ Cable guide — kit W575392
- ⑤ Front derailleur cable
- ⑥ Rear derailleur cable
- ⑦ Front brake hose
- ⑧ Rear brake hose
- ⑨ Dropper post cable

## Cable routing order

Route all cables from the top of the down tube to the bottom bracket (except the front brake hose).

1. Dropper post — use a magnet to guide the cable down the down tube and through the upper hole in the bottom bracket shell.

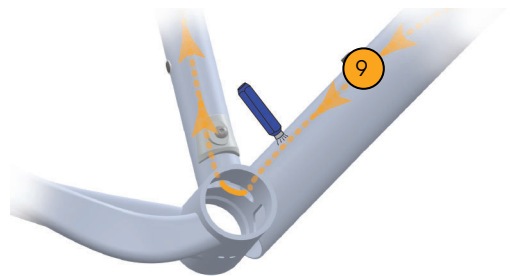

2. Rear derailleur cable
3. Rear brake hose
4. Front derailleur cable
5. Front brake hose

# T47 bottom bracket

## Install the bottom bracket

1. Apply grease to the threads on both sides of the frame.

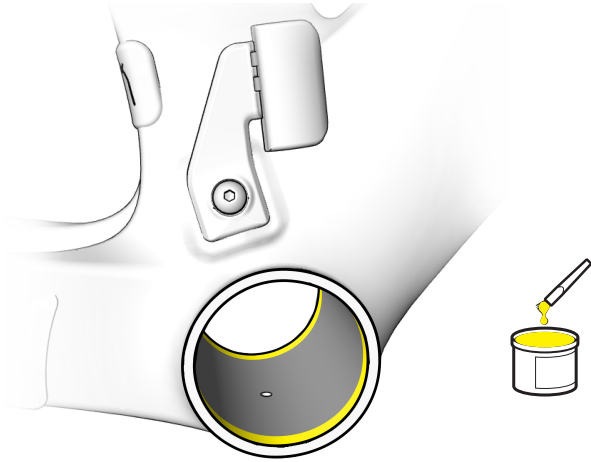

2. Using your hands, thread the bottom bracket onto the frame.

**NOTICE:** Do not start tightening the bottom bracket with a tool. Dirt and other contaminants can damage the threading.

3. Use the proper tool to torque both sides to specification (see the [Tool and spline compatibility](#) table below).
4. If necessary, add spacers before installing the cranks (see the [Spacers required](#) table at the top right).

## Tool and spline compatibility

	Tool Model Part number	Praxis		Unior	Park Tool	Wheels Mfg	CeramicSpeed
		TP-2400 594148	TP-3028 594147	1671.T47 1043614	BBT-47 568922	BBTOOL-48-44 589307	—
Bottom bracket manufacturer	Praxis	24mm	X		X		
		30mm		X	X		
	Wheels MFG					X	
	SRAM DUB				X	X	
	Chris King				X	X	
	Ceramic-Speed	24mm			X	X	
GXP							X

## Spacers required

The table below contains bottom bracket/crank combinations that require spacers. Your bicycle may have other combinations that do not require spacers.

Crank	Bottom bracket	Spacers required		
		Drive side	Non-drive side	
Shimano	CeramicSpeed 24mm	0.5mm	0.5mm	
SRAM	DUB	SRAM DUB	2-3mm	—
	GXP	Wheels MFG	1.0mm	—

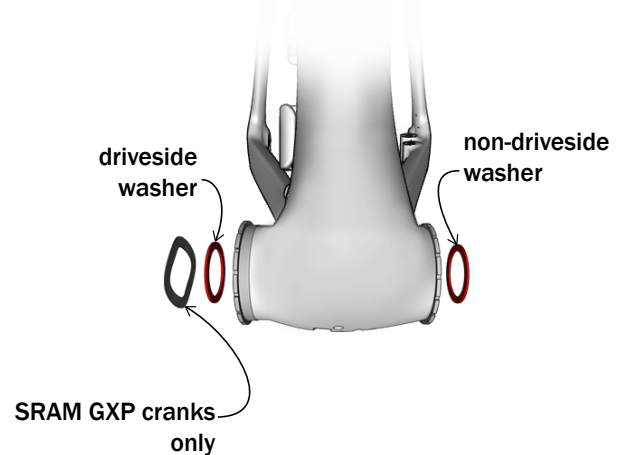

# Fork and headset

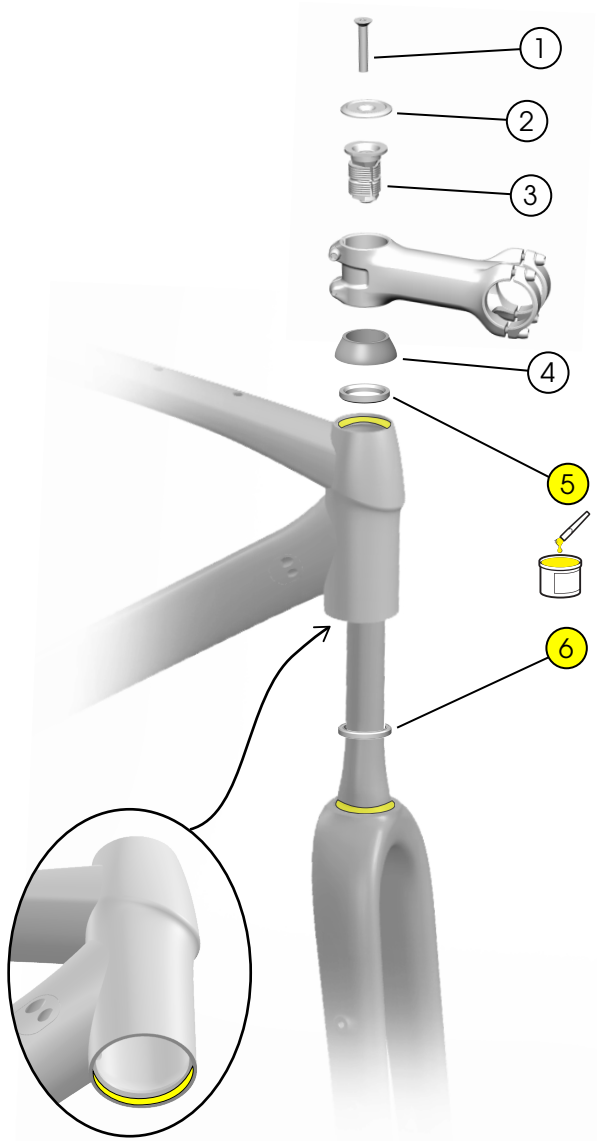

- ① Top cap bolt
  - ② Compression plug cap
  - ③ Compression plug
  - ④ Bearing cover
  - ⑤ Headset bearings – W531676
  - ⑥ Headset bearings – W540243
- } W547432

# Chainkeeper

## Adjust the 1x chainring chainkeeper

1. Shift to the lowest gear (largest rear cassette cog).
2. Loosen the screw on the back of the chainkeeper.
3. Move the loose piece up or down so there is 1mm of vertical clearance above the chain.
4. Tighten the screw on the back of the chainkeeper.

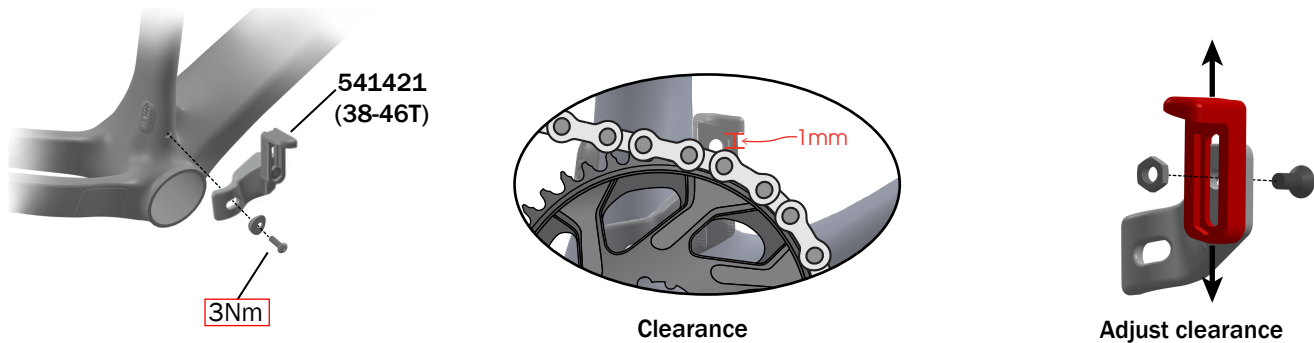

## Adjust the 2x chainrings chainkeeper

1. Shift to the lowest gear (largest rear cassette cog) and inner chainring.
2. Loosen the screw holding the chainkeeper in place.
3. Rotate the chainkeeper around the seat tube so there is 1mm of horizontal clearance to the chain.
4. Tighten the screw to 3Nm.

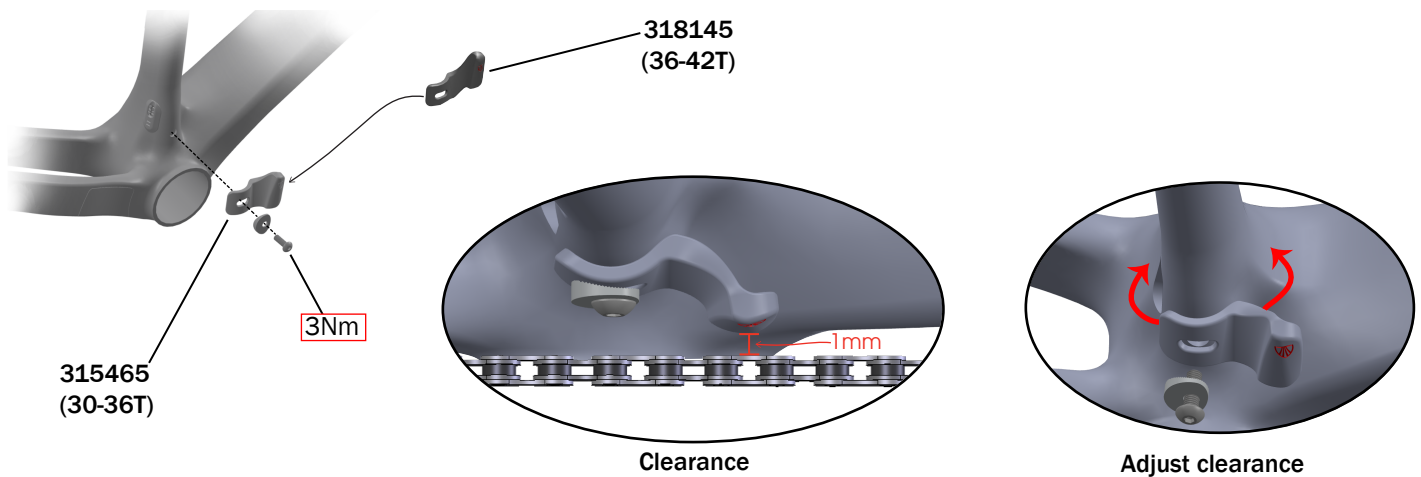

# Accessories

## Mounting inserts

All mounting inserts are M5x0.8.

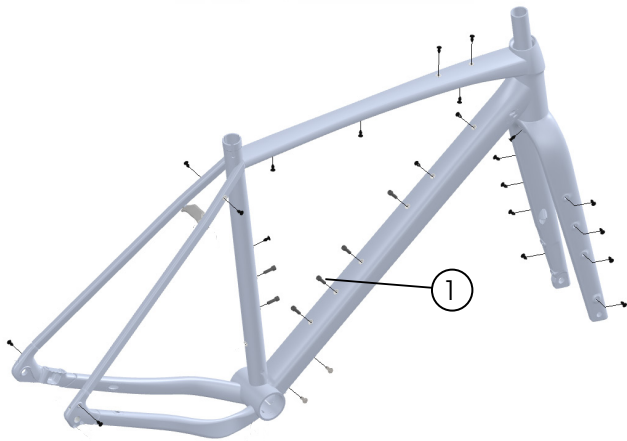

- ① Bolts (M5x16mm) – W438323
- ② Frame bag
- ③ Fender mount bolts – W331954
- ④ Fender mount bridge – W575637
- ⑤ Bolts (M4x10mm) – W330683

## Rack, fenders, and frame bag

**WARNING:** Use only steel fasteners to attach racks, bags, and fenders. Do not use aluminum fasteners as they are not rated for these loads.

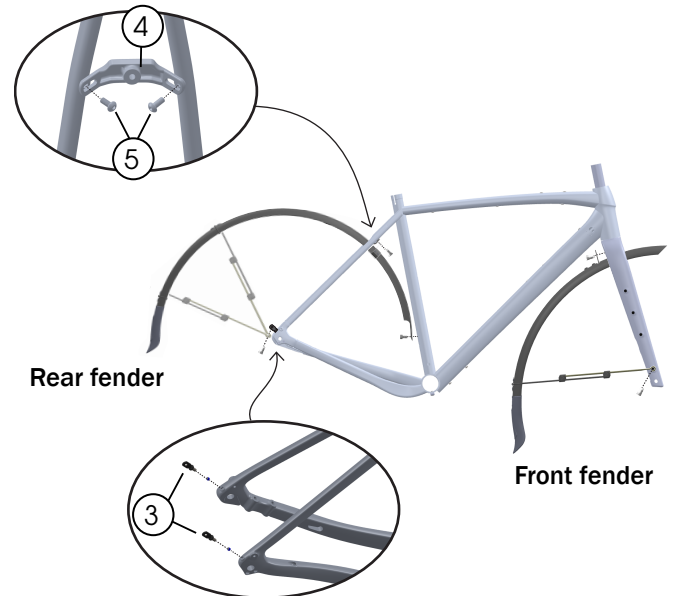
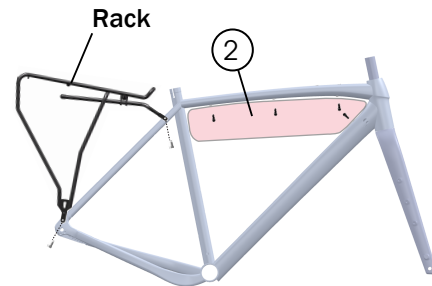

# Specifications

	ALR
<b>Rear hub OLD</b>	142mm
<b>Seat post OD</b>	27.2mm
<b>Seat post clamp ID</b>	31.9mm
<b>Upper fork steer tube OD</b>	28.6mm
<b>Head tube OD, top/bottom</b>	45mm/55.5mm
<b>BB type/width</b>	T47/85.5mm
<b>Brake rotor diameter min/max</b>	140/160mm
<b>Front derailleur clamp ID</b>	31.8mm
<b>Tire width max 700c (without fenders)</b>	45mm (1.8")
<b>Tire width max 650b (without fenders)</b>	56mm (2.2")
<b>Fender mount – rear</b>	Yes
<b>Fender mount – front</b>	Yes
<b>Rack mount</b>	Yes
<b>Dropper post compatibility</b>	Yes

	Chainline	Max chainring teeth (T)		
		Small	Large	Single (1x)
<b>Shimano GRX</b>	49.7mm	–	–	50T
	47mm	42T	52T	–
<b>Shimano</b>	43.5mm	36T	50T	–
<b>SRAM</b>	45mm	–	–	46T
	45mm	37T	50T	–
<b>SRAM WIDE</b>	47.5mm	–	–	48T
	47.5mm	44T	50T	–